



## Forget a Wireless Network on macOS

If you have trouble connecting to a wireless network, it can be helpful to remove the network from the list of preferred networks, and then attempt to reconnect.

These instructions illustrate macOS 11, Big Sur. Your computer may appear differently.

If you have questions, please use the online help form at <https://ithelp.umassd.edu>, contact the IT Service Center at 508-999-8900 option 5, or email [itscenter@umassd.edu](mailto:itscenter@umassd.edu).

1. Open the Apple menu in the upper left corner, and click to select **System Preferences**.
2. Click the **Network** icon in the second row.

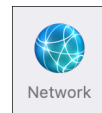

The Network preferences are displayed.

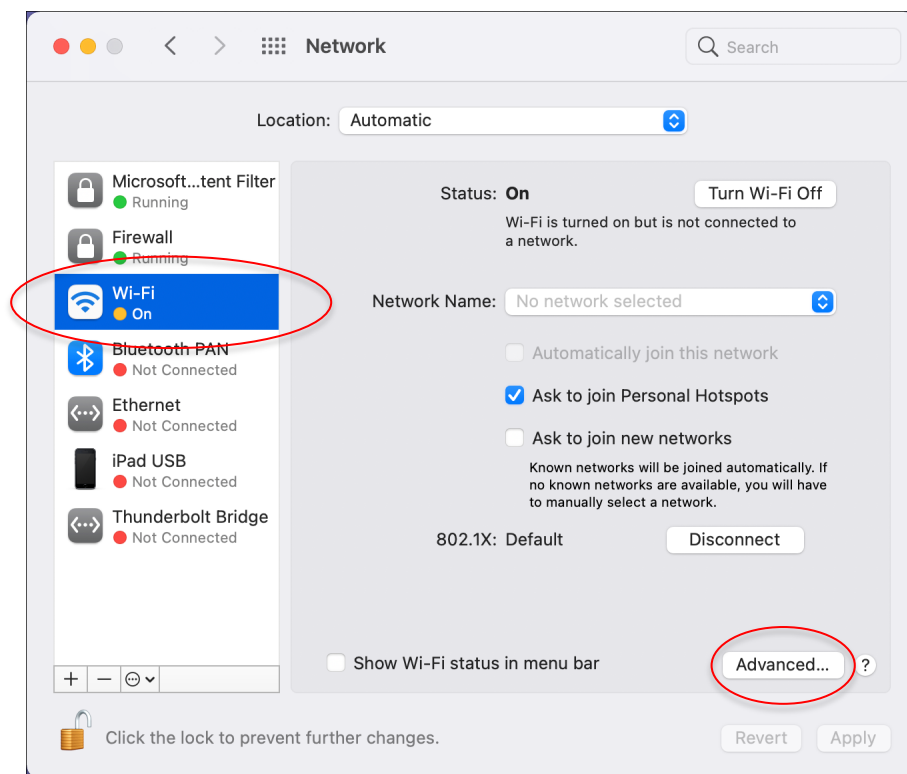

3. Click to select **Wi-Fi** in the left column
4. Click the **Advanced...** button in the lower right.



5. The Advanced Wi-Fi settings are displayed.

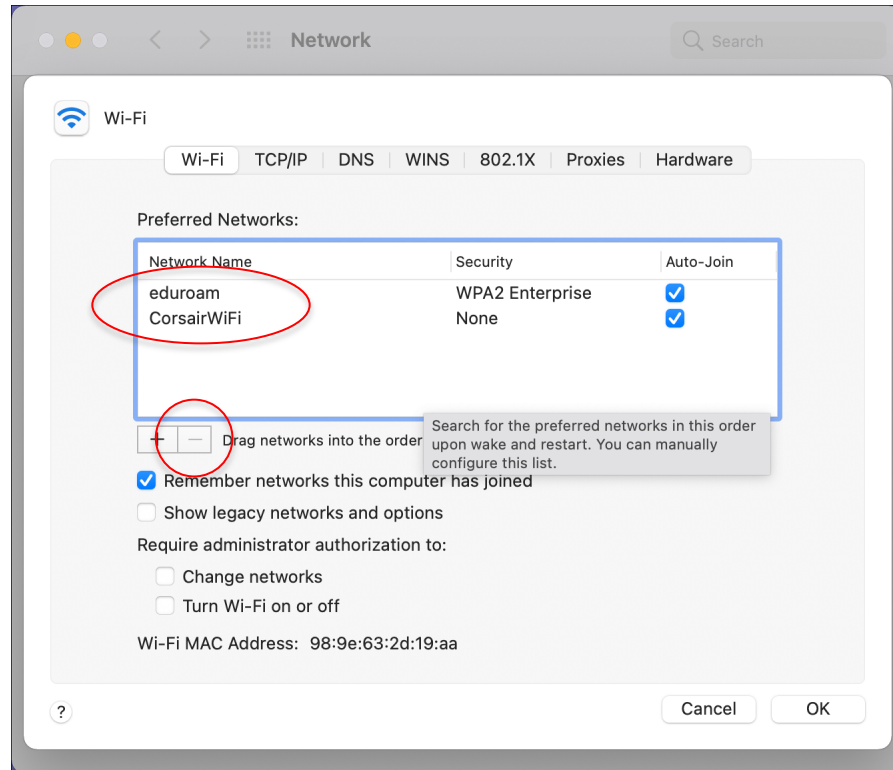

Click to select **eduroam**, then click the minus (-) button below the network list.

Click to select **CorsairWiFi**, then click the minus (-) button below the network list.

6. Click the **OK** button in the lower right.
7. Click the **Apply** button in the lower right.
8. Quit the System Preferences.